

1394 6P FEMALE

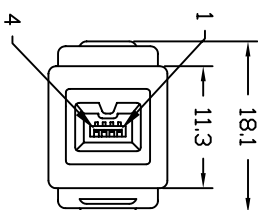
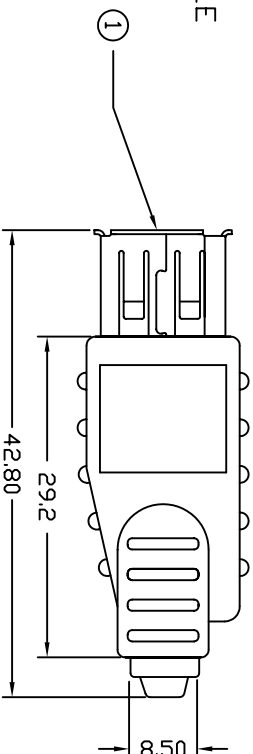
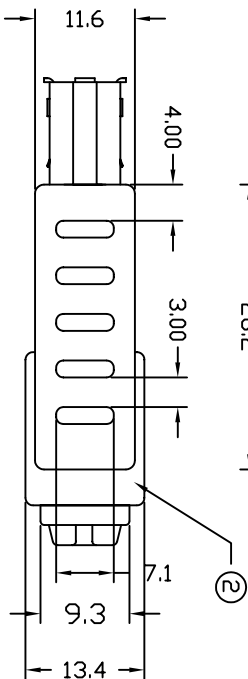
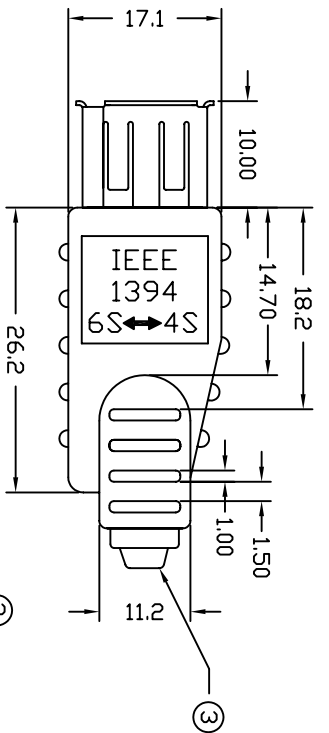

1394 4P FEMALE

PIN ASSIGNMENT

1394 6P FEMALE	5	6	3	4	SHELL
1394 4P FEMALE	1	2	3	4	SHELL

ELECTRONIC TEST:
 1.OPEN/SHORT/INTERMITT:100%.
 2.INSULATION RESISTANCE:10MΩ.
 3.CONTACT RESISTANCE:100Ω.
 4.THE WIRES THAT THEY ARE SOLDERED
 IN THE PIN #5 AND #6 OF THE 1394 6P
 FEMALE ARE THROUGH THE CORE.

5	INTERNAL WIRE:UL1007 30AWG 7 STRAND L:17MM	PCS	5
4	CORE:F18RID6.4mm*3.2mm*3.5mm	PCS	1
3	1394 4P TYPE FEMALE INSULATION:BLACK IN COLOR	PCS	1
2	PVC MOLDED WITH COPPER FOIL BLACK IN COLOR	PCS	1
1	1394 6P TYPE FEMALE INSULATION:WHITE IN COLOR	PCS	1
ND.	DESCRIPTION	UNIT	QTY
A	ADP-1394-4F6F IEEE ADAPTER	IEEE 1394 ADAPTER 4PIN FEMALE TO 6PIN FEMALE MOLDED	07/03/01
REV.	DESCRIPTION	DATE	

UNLESS OTHERWISE SPECIFIED TOLERANCE

ANG.	0°	F0.5
	±0.0	±0.3
	±0.0	±0.2

SCALE: 1:1 UNIT: mm

DRAWN MICHAEL 07/03/01

CHECKED HENRY 07/03/01

APPROVED JIMMY 07/03/01

PRODUCT NO. ADP-1394-4F6F

FILE NAME: ADP-1394-4F6F

DUN CHENG TECH. CORP.
 TEL:886-2-26739970 FAX:886-2-26739980

